



## CURBS PLUS INC.

### ROOF CURBS

Insulated



18-ga. galvanized steel construction; welded one-piece design. Features 2 x 2 pressure-treated wood nailer and 1-1/2" thick fiberglass insulation.

Outside Dim. In.

W x L x H

No.	W x L x H
CPC-3-121212	12 x 12 x 12
CPC-3-151512	15 x 15 x 12
CPC-3-16512	16.5 x 16.5 x 12
CPC-3-171712	17 x 17 x 12
CPC-3-18512	18.5 x 18.5 x 12
CPC-3-18523	18.5 x 18.5 x 23
CPC-3-191912	19 x 19 x 12
CPC-3-22512	22.5 x 22.5 x 12
CPC-3-22521	22.5 x 22.5 x 21
CPC-3-232312	23 x 23 x 12
CPC-3-26512	26.5 x 26.5 x 12
CPC-3-272712	27 x 27 x 12
CPC-3-28512	28.5 x 28.5 x 12
CPC-3-28518	28.5 x 28.5 x 18
CPC-3-292912	29 x 29 x 12
CPC-3-34512	34.5 x 34.5 x 12
CPC-3-34518	34.5 x 34.5 x 18
CPC-3-58512	58.5 x 58.5 x 12

## CURBS PLUS INC.

### ROOF EQUIPMENT SUPPORTS

18-ga. galvanized steel construction; welded one-piece design. Features full-depth C-channel reinforcement and 6" spreader channels on 12" centers; 2 x 4 pressure-treated wood nailer. Galvanized counterflashing attached with tek screws and neoprene washers.

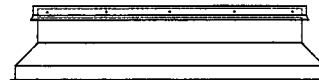

No.	Dim. L x H
CPES-3-0212	2' x 12"
CPES-3-0312	3' x 12"
CPES-3-0412	4' x 12"
CPES-3-0612	6' x 12"

## LUMALIER

### AIR DISINFECTORS

Ultraviolet

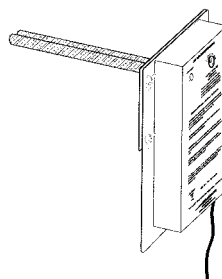

Installs into side of standard air duct using 3.5" diameter cutout. Features aluminum reflectors to enhance efficiency, inspection port to view lamp condition, and safety interlock switch. Measures 12.31" L x 7.25" W (including mounting plate) x 2.13" D (without lamp). 120-277V, 50-60Hz. Includes (1) PL-S L35W/TUV lamp and 9-ft. power cord with plug.

No.	Dim. In. H x D	Watts	Lamp Life Hrs.
ADPL-136	6 x 17	35	9000

## DAIKIN AC

### HEAT PUMPS

#### Indoor Units – Series FTXS

For single zone applications. Features air-purification filter, flat panel design, temperature setback and power-saving Intelligent Eye. Wireless remote controller. For use with R410A refrigerant. 208/230V, 60Hz, 1 phase. **Note:** Combine with Series RX outdoor unit to form complete system.



No.	Cap. BTUH		CFM	dB(A) Hi/Med/Low		Dim. In. H x W x D
	Cooling	Heating		Cooling	Heating	
DAI-FTXS09DVJU	8500	10,000	253-220-187	38/32/25	38/33/28	10-3/4 X 30-7/8 X 7-11/16
DAI-FTXS12DVJU	11,500	11,500	286-237-187	40/33/26	39/34/29	10-3/4 X 30-7/8 X 7-11/16
DAI-FTXS18DVJU	18,000	21,600	609-529-448	45/41/36	44/40/35	11-7/16 x 41-5/16 x 9-3/8
DAI-FTXS24DVJU	22,000	24,000	586-532-477	46/42/37	46/42/37	11-7/16 x 41-5/16 x 9-3/8

### HEAT PUMPS

#### Outdoor Units – Series RX

For single zone applications. Compact, lightweight design. 13 SEER. HSPF 7.7. Operating range 14°F to 115°F cooling, 5°F to 64°F heating. For use with R410A refrigerant. 208/230V, 60Hz, 1 phase.

**Note:** Combine with Series FTXS indoor unit to form complete system. **Available in 13 or 16 SEER;** specify when ordering.

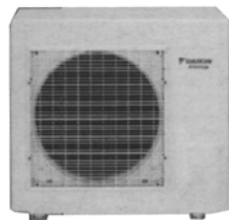

No.	Cap. BTUH	dB(A)	Max. Piping Lgth. Ft.	Max. Height Diff. Ft.	Dim. In. H x W x D
DAI-RX09FVJU	9000	50/51	66	49	21-5/8 x 30-1/8 x 11-1/4
DAI-RX12FVJU	12,000	51/53	66	49	21-5/8 x 30-1/8 x 11-1/4
DAI-RX18FVJU	18,000	53/53	98	66	28-15/16 x 32-1/2 x 11-13/16
DAI-RX24FVJU	24,000	54/54	98	66	28-15/16 x 32-1/2 x 11-13/16

#### Accessories

No.	Desc.
DACA-CFK-1	Conical flaring tool
DACA-FSG-1	Flare size gauge
DACA-SVA-1	5/16" to 1/4" adapter



FLASHINGS

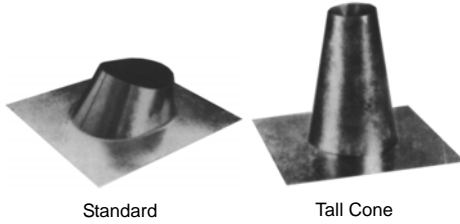

Standard

Tall Cone

**Standard.** Fits flat to 5/12 pitch roofs. Double-seam construction prevents leakage.

**Tall Cone.** Fits flat to 1/12 pitch roofs. Prevents leakage when used on flat roofs in snow-packed areas.

No.	Desc.	For Pipe Dia. In.
BVENT-4EF	Standard	4
BVENT-6EF	Standard	6
BVENT-8RFT	Tall cone	8
BVENT-10RFT	Tall cone	10

UNIVERSAL CAPS  
Model C

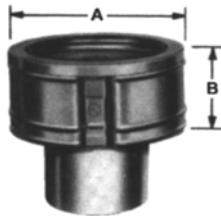

Prevents wind from blowing exhaust gases back into structure. Allows vent termination at minimum height above roof. UL listed.

No.	For Pipe Dia. In.	Dim. In.	
		A	B
BVENT-10C	10	15-3/4	7-1/2

UNIVERSAL CAPS  
Model CW

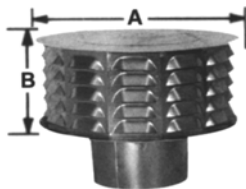

Prevents wind from blowing exhaust gases back into structure. Features ports and baffles to protect against rain and debris. Allows vent termination at minimum height above roof. UL listed.

No.	For Pipe Dia. In.	Dim. In.	
		A	B
BVENT-4CW	4	6-3/4	4-3/8
BVENT-6CW	6	9-7/8	5-3/4
BVENT-8CW	8	12-7/8	7

DAMPER REGULATOR EXTENSION KITS

For use with insulation. Includes shaft extension with locking screw and damper regulator extension.

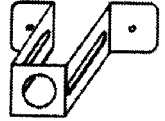

No.	Stand-Off In.
EXT SHAFT KIT	1-1/2

QUADRANT REGULATORS

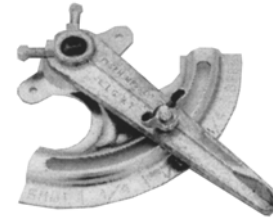

Plated steel construction with die-cast handle. Fully assembled with set-screws and lock washer.

No.	For Ext. Shaft	
	Type	Sz. In.
RP-4C	Square	3/8
RP-5CR	Round	1/2



PIPE SUPPORTS  
Model 1.5

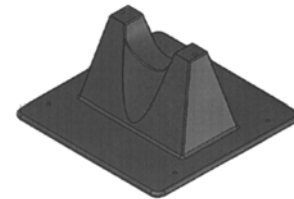

For supporting roof-mounted gas pipes, electrical conduit or mechanical piping. Polycarbonate resin construction; compensates for thermal expansion and contraction of pipe, preventing damage to roof.

No.	Max. Pipe Sz. In.		Max. Load Lbs.	Base Dim. In.
	ID	OD		
MIRO-1.5	1.5	1-9	80	6 x 6

PIPE SUPPORTS  
Model 3R

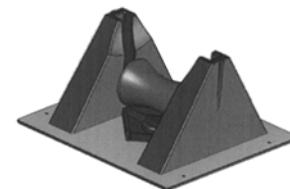

Roller bearing design for supporting roof-mounted gas pipes, electrical conduit or mechanical piping. Polycarbonate resin construction; compensates for thermal expansion and contraction of pipe, preventing damage to roof.

No.	Max. Pipe Sz. In.		Max. Load Lbs.	Base Dim. In.
	ID	OD		
MIRO-3R	3	3.75	100	7 x 7